

SGBD-1.8/SGBD-3.2/SGBD-4.0

Compact Residential Gas Meter
Jet Oscillator Technology

Application

Liquid Petroleum Gas (LPG) & Natural Gas

Features

- Remote Data Transmission
- Compact & Light Weight – 250 grams
- Estimated Battery Life – 12+ years
- Calibration Interval – 12 years
- Housing – Aluminium
- Overlay Cover – ABS plastic – 11 colours
- Thermal Correction - Optional
- Communication – Bluetooth Low Energy (BLE)
- Rating – IP50



Description

The compact Elephant SGB residential gas meters are designed by Russian aviation radio engineers and patented with jet oscillator technology for measuring gas flow. The principle of operation is based on converting the volume of gas that has passed through the meter into a proportional number of electrical impulses using a jet oscillator, followed by counting on an electronic unit for measuring the volume of gas. Elephant Meters are approved according to GOST 20448-90 (LPG) and GOST 5542-87 (Natural Gas) by Russian Federal Agency for Technical Regulation and Metrology (Rosstandart).

Technical Index

Parameter		Unit	Model		
			1.8	3.2	4.0
Minimum Flow Rate (Qmin)		m ³ /h	0.03	0.06	0.08
Maximum Flow Rate (Qmax)		m ³ /h	1.8	3.2	4.0
Pressure Loss at Qmax		Pa	≤200		
Maximum Working Pressure		kPa	5		
Relative error range	Qmin to 0.2 Qmax	%	± 2,5		
	0.2 Qmax to Qmax	%	± 1,5		
Operating Temperature		°C	-10 to +50		
Relative humidity of Air (temp. not higher than 25 °C)		%	30 to 80		
Atmospheric pressure		kPa	84 to 106.7 (from 630 to 800 mm Hg)		
Power supply from the built-in power supply		V	3.6		
Mass of the meter		Kg	0.3		
The lowest price for dividing the counting device of counters		m ³	0.001		
Maximum Cumulative Reading		m ³	99999.999		
Outlet Connection Size		Inch	G 1/2"		
Inlet Connection Size		Inch	Bayonet Nut G 1/2" or G 3/4"		

Dimensions

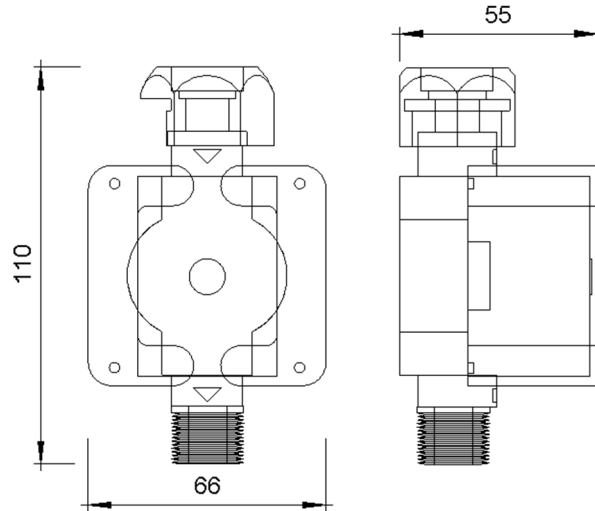

Colour Pads



*Illustrative Image

Order Codes

Part Number	Description	Inlet Bayonet Nut
60039-E-107	SGBD-1.8	G $\frac{1}{2}$ "
60039-E-108	SGBD-3.2	G $\frac{1}{2}$ "
60039-E-109	SGBD-4.0	G $\frac{3}{4}$ "
60039-E-110	SGBD-1.8-TC	G $\frac{1}{2}$ "
60039-E-111	SGBD-3.2-TC	G $\frac{1}{2}$ "
60039-E-112	SGBD-4.0-TC	G $\frac{3}{4}$ "

Accessories



Remote Display