



TATSA[®]
CALIDAD INDUSTRIAL DESDE 1955

NEW COATING

Anticorrosive advanced protection*
double coat; technological
innovation system that combines
cathodic and barrier protection.

ABOVEGROUND DOMESTIC TANKS



GENERAL SPECIFICATIONS

Designed and manufactured in accordance with ASME Code for Pressure Vessels, Section VIII, Div. 1. Steel meets ASME specifications.

SPECIFICATIONS

Design pressure at 250 PSI.
Design temperature 125°F
Hydrostatic test pressure at:
325 PSI min.
395 PSI max.

TECHNICAL DATA

VALVES AND FITTINGS

	INLET CONNECTION
Multivalve (Includes service valve, equalizing valve, liquid level)	3/4" NPT
Filler valve	1 1/4" NPT
Check lock valve	3/4" NPT
Safety relief valve:	
From 120 to 320 WG	3/4" NPT
500 WG	1" NPT
1000 WG	1 1/4" NPT
2000 WG	1 1/4" NPT
Drain coupling (Provided only in 500, 1000 and 2000 WG.)	
Liquid level magnetic gauge	1" NPT

OUTLET CONNECTION

Pol Connection
ACME 1 3/4"
1 5/8" UNF
1 1/4" NPT

VALVES AND FITTINGS

(Basic equipment for 120 & 150 capacities)

Service valve
Filler valve
Safety relief valve
Liquid level magnetic gauge
Dome

INLET CONNECTION

3/4" NPT
1 1/4" NPT
3/4" NPT
1"

OUTLET CONNECTION

Pol Connection
1 3/4" ACME

ANTICORROSIVE PROTECTION SYSTEM

Abrasive blast cleaning to SSPC-SP10 / NACE 2 / ISO 8501-1 Sa 2 1/2 grade (near white).

Anticorrosive advanced protection* double coat; technological innovation system that combines cathodic and barrier protection.

*the 2000 gallons tank are protected with a polyurethane high performance coating.

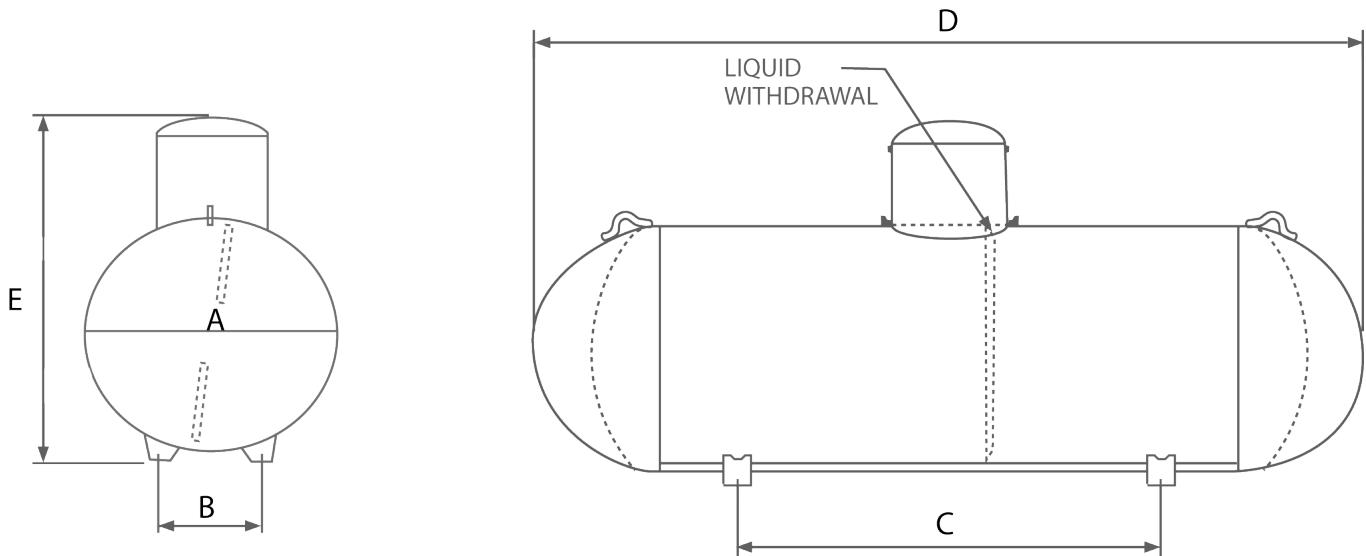

MODEL		NOMINAL CAPACITY		WEIGHT		DIAMETER (A)		WIDTH BETWEEN SUPPORTS (B)		DISTANCE BETWEEN SUPPORTS (C)		OVERALL LENGTH (D)		OVERALL HEIGHT (E)	
LITERS	U.S. GALLONS	LITERS	U.S. GALLONS	KG.	POUNDS	METERS	INCHES	METERS	INCHES	METERS	INCHES	METERS	INCHES	METERS	INCHES
454	120	446	118	111.1	245	0.61	24	0.26	10 1/8"	0.91	3'-0"	1.67	5'5 7/8"	0.82	2'-8 1/4"
946	250	965	255	214.1	472	0.80	31.5	0.32	12 3/4"	1.07	3'-6"	2.20	7'-2 1/2"	1.00	3'-3 3/4"
1,211	320	1,230	325	266.7	588	0.80	31.5	0.32	12 3/4"	1.22	4'-0 1/4"	2.74	8'-11 3/4"	1.00	3'-3 3/4"
1,893	500	1,885	498	395.1	871	0.95	37.4	0.38	15"	1.52	5'-0"	2.99	9'-10"	1.16	3-9 3/4"
3,785	1,000	3,770	996	784.3	1,729	1.04	40.96	0.41	16 1/4"	2.74	9'-0"	4.85	15-10 7/8"	1.25	4'-1 3/8"
3,785	1,000	3,811	1,007	842	1,856	1.143	45.00	0.41	16 1/4"	2.74	9'-0"	4.00	157 1/2"	1.357	53.437"
4,732	1,250	4,698	1,241	907	1,999	1.04	40.96	0.41	16 1/4"	3.89	153 7/16"	5.9	235"	1.25	4'-1 3/8"
7,570	2,000	7,620	2,013	1667.5	3,676	1.18	46.77	0.533	21"	6.096	20'-0"	7.24	23'-9"	1.71	4'-7"
7,570	2,000	7,488	1,978	1423	3,137	1.04	40.96	0.483	19	4.94	194 1/2"	9.32	367 1/16"	1.27	50 1/8"
7,570	2,000	7,842	2,072	1,396	3,078	1.143	45.00	0.533	21"	4.877	192.0"	8.026	316"	1.357	53.437"